

# Vertigo Steatite

Space & energy-saving water heater with premium flat design

## Vertigo Installation Guide.

All Vertigo units must be installed horizontally.

A. No tray is required if the hot water system is located in an area that has a floor drain such as a laundry, bathroom or en-suite.

Or

B. Has a leak protection unit installed on the cold water line or at the mains. Importantly, if such a device is installed at the mains, other areas and appliances will be protected such as kitchens with dishwashers. Such as system would also stop damage from future leaking pipes.

Or

C. If A or B is not possible, then a tray must be installed with a connection to the waste water system.

Mount the Vertigo on the wall.

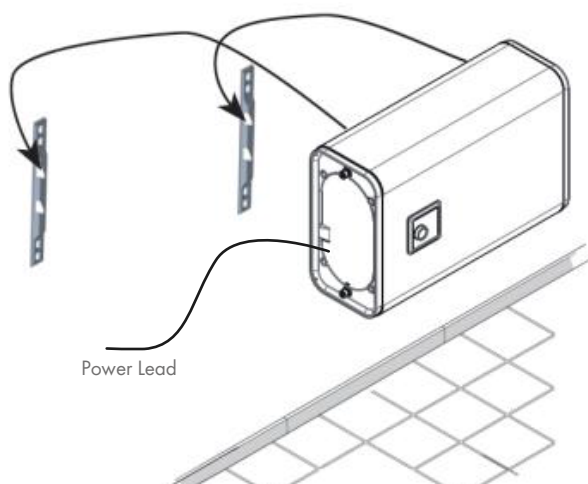

## INSTALLATION DIMENSIONS (in mm)

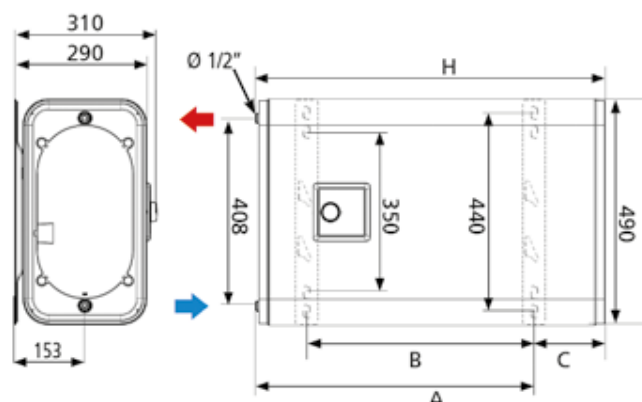

## Electrical Requirements

Single phase 10 amp power supply required.

## VERTIGO STEATITE Multiposition installation

### TECHNICAL DATA

MODEL	REAL CAPACITY (L)	INSTALLATION	MAXIMUM POWER OUTPUT (W)	POWER OUTPUT EXIT TANK (W)	POWER OUTPUT ENTRY TANK (W)	TOTAL HEAT-UP TIME $\Delta T=50^{\circ}\text{C}$	HEAT-UP TIME EXIT TANK (WITHOUT BOOST)
VERTIGO STEATITE 823014	25	V/H	1 000	1 000	1 000	1h32	0h46
VERTIGO STEATITE 833019	40	V/H	2 250	1 500 + 750	1 000	2h02	0h49
VERTIGO STEATITE 843039	65	V/H	2 250	1 500 + 750	1 000	3h19	1h19
VERTIGO STEATITE 853070	80	V/H	2 250	1 500 + 750	1 000	4h04	1h38

### DIMENSIONS

MODEL	HEIGHT (H)	WIDTH (W)	DEPTH * (D)	DIMENSIONS (mm)				NET WEIGHT (kg)	ERP ENERGY CLASS
				A	B	C	D		
VERTIGO STEATITE 823014	601	490	290	440	280	310	155	25	B
VERTIGO STEATITE 833019	765	490	290	610	500	310	155	28	B
VERTIGO STEATITE 843039	1090	490	290	975	700	310	115	33	B
VERTIGO STEATITE 853070	1300	490	290	1185	800	310	115	39	B